

# OG14 LEG PRESS

## PRODUCT GUIDE

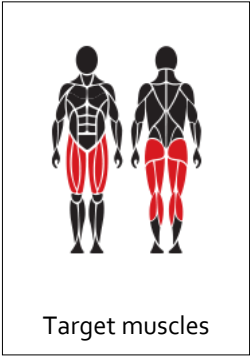

### PRODUCT FEATURES

- Effective and safe exercise equipment
- Adjustable loading:
  - 75-165 kg (2 x weight unit)
  - 2,5 kg increments
- Adjustable seat (distance)
- Maintenance-free
- Can be installed on a movable platform

### COLOR OPTIONS

The product comes as standard in RAL Classic colors:  
RAL 5012 (blue), RAL 3020 (red), RAL 6018 (green)  
RAL 1017 (yellow), or RAL 7024 (grey).



Other RAL colors are available at an additional cost.

# OG14 LEG PRESS

## D I M E N S I O N S

Length	3145 mm
Width	1140 mm
Height	1800 mm
Equipment weight	435 kg (2 x weight unit)

## M A T E R I A L

Metal parts	Steel
Movement Arm	Stainless steel
Tube Strengths	3-6 mm
Coating solution	Zink and powder coating electropolishing

## C O U N T R Y / S T A N D A R D

Country of manufacture	Finland
Standard	EN16630

## B A S E O P T I O N S

- A. Concrete      Surface mounting to concrete
- B. Platform      Installed on movable platform

## F O U N D A T I O N

For example: artificial turf or moldable safety platform  
Concrete min 120 mm below equipment  
Ground frost insulation, thickness based on the ground

Instruction guide included in delivery:  
installation instructions, maintenance, usage info.  
Contact: [info@omnigym.com](mailto:info@omnigym.com)

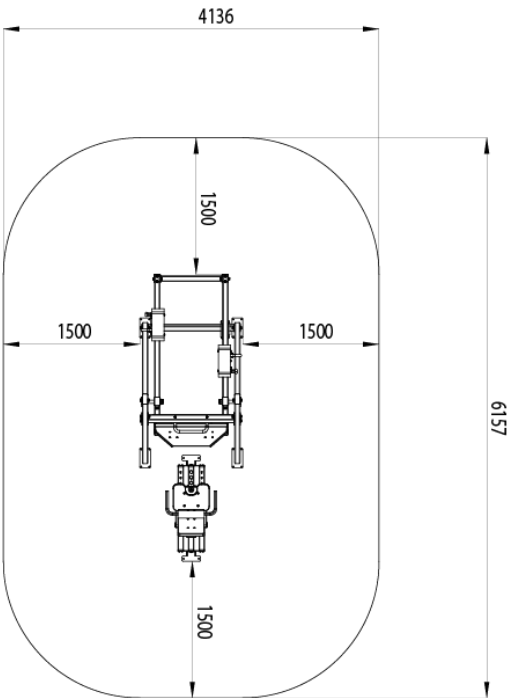

## EN16630